



### BGLED-HEAD-PORT

Complete head with Red LED array, lense, screen, circuit, and plug.

### BGLED-HEAD-STAR

Complete head with Green LED array, lense, screen, circuit, and plug.

### BGLED-HEAD-STERN

Complete head with White LED array, lense, screen, circuit, and plug.

### BGLED-HEAD-FL

Complete head with Amber LED array, lense, screen, circuit, and plug.

### BGCMPE

Steady control module with photoelectric control for port, starboard, and stern steady lights only.

### BGCMFLPE

Flashing amber control module with photoelectric control.

### BGCMPEEP

Flashing amber control module with peep light.

### BGLED888-STD-COVER-ASSY

Complete cover assembly black cup, bezel, switch, contact plate, bale handle.

### BGBZ

Black bezel for securing head to base.

### BG888-ORING

18" silicone black o-ring.

### BGCUP-ASSY

Black threaded cup assembly.

### BGLED888-HANDLE

Black bale handle, 2 bolts, 4 washers, 4 nuts.

### BG-888-COVER-RAW

Cover with black lens holder.

### BGBOX

Raw yellow bottom.

### BGMAGAS

Magnet assembly: 1 magnet, 2 washers, 1 nut, 1 screw, and protective disc. (All stainless)

### BGSW

On/Off toggle switch.

### BGSB

Rubber boot for toggle switch.

### BGPHOTO-EYE-DOME

Plastic see-thru dome for photo eye.

### BGAXEL-PULL

Removable stainless steel pull pin.

### BGAX

Stainless steel axle.

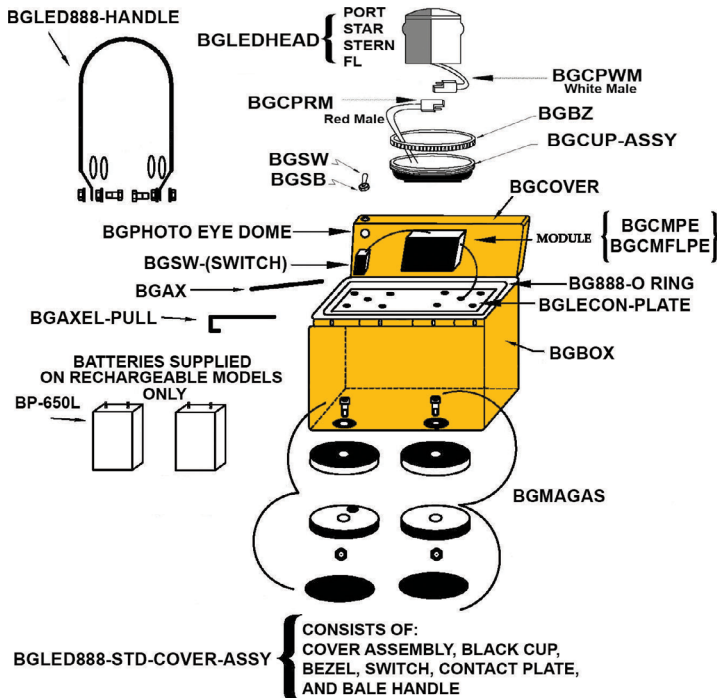



### BGLECON-PLATE

Battery contact plate with 2 brass eyelets.

### BP-650L

Replacement rechargeable 6 volt spring top battery.

### BGCPWM

6" wire with polarized plug with White as male.

### BGCPRM

6" wire with polarized plug with Red as male.

### BATTERY-509A

Alkaline spring top battery.

